

# Welded Valve Configurations

Welded valve configurations are designed to improve the process in aseptic production facilities by reducing the dead legs in accordance to cGMP. Welded valve configurations may be as simple as a valve by tube fabrication or as complex as multiple valve bodies of different sizes welded into a valve cluster. All welded end connections are available. The applications are endless and the challenge is to efficiently meet the process needs.

Strict quality control is followed for every welded valve configuration produced by SED. All weld seams that are accessible are polished according to the interior surface specification.

The completed welded valve configuration is visually inspected and 100% are pressure tested.

### Advantages of a Welded Valve Configuration:

- Totally self draining
- Minimized dead legs
- Reduces surface contact and hold up volume of the medium
- Compact assembly
- Reduces number of welds
- Provides a ready-made assembly for field installation

During installation of welded valve configurations it is important to follow good piping practice to guarantee the valve assemblies drainability.

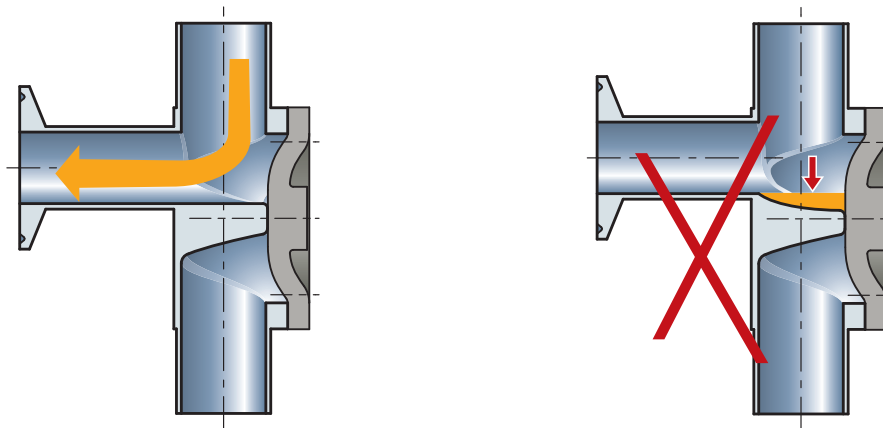

# Welded Valve Configurations

The main valve orientation distinguishes between the two different principles: SL or SA

## 1) SL – L Pattern Configurations

The SL Fabrication is utilized in a vertical piping system to eliminate dead legs in point of use applications of high purity water systems or any other distribution systems. This valve design serves as a 90-degree elbow for the piping system or as a valve by valve configuration. In a valve by valve configuration the horizontal valve is orientated at the self-draining angle.

When the vertical main valve is opened it provides a sample untainted by bacterial growth or process contamination. The size range available is up to DN 100 (4") for both the main valve and L valve or tube port.

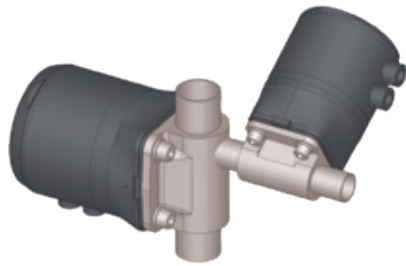

SL1.H

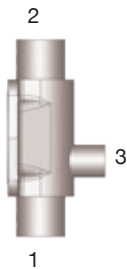

SL2.H

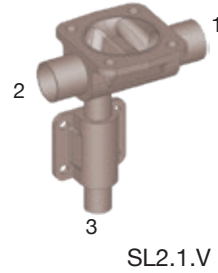
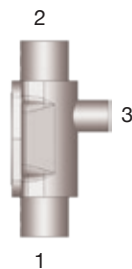

SL2.1.V

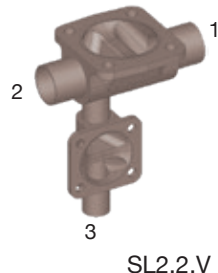

SL2.2.V

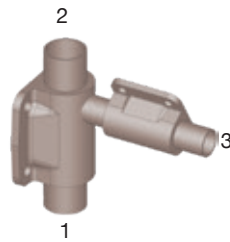

SL2.1.H

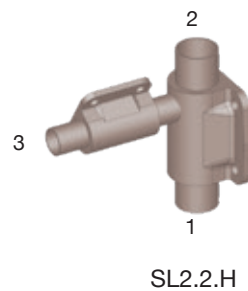

SL2.2.H

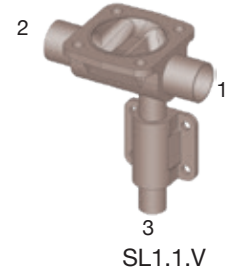

SL1.1.V

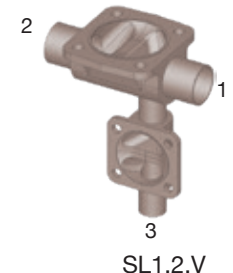

SL1.2.V

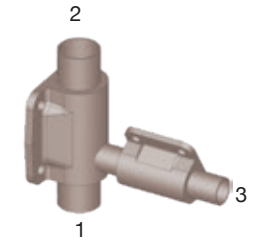

SL1.1.H

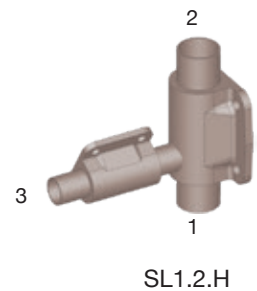

SL1.2.H

On request, all dimensional data sheets or 2D and 3D - CAD drawings are available.

All fabricated 2/2 way SA and SL orientations will have a dead leg. Manufacturing these valve orientations from a solid block body will minimize or eliminate the dead leg. See page 68 – 81.

# Welded Valve Configurations



## 2) SA – Sterile Access Configurations

The Sterile Access Fabrication is utilized in a horizontal piping system where the main valve is orientated at the self-draining angle and the access port is at the lowest drainable point of the waterway.

The sterile access maybe used for applications including sampling, steam, condensate or divert port.

The Sterile Access Fabrication is available with either a tube port or a vertical or horizontal valve port.

The size range available is up to DN 100 (4") for both the main valve and access valve or tube port.

Sterile access fabrications use two standard 2/2 way valve bodies welded together per the required orientation. In some same size (i.e. DN25 x DN25) sterile access fabrications a block body main valve may be selected for manufacturing.

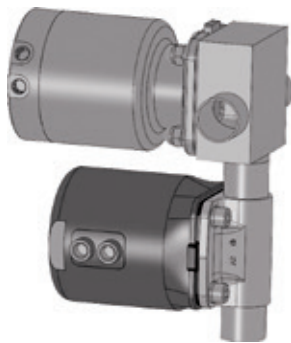
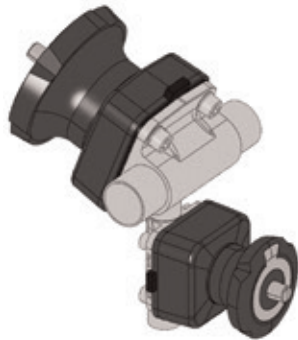

SA1.V

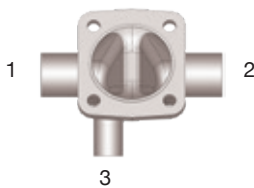

SA2.V

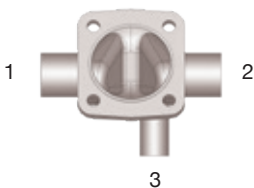

SA1.1.V



SA2.1.V



SA1.2.V

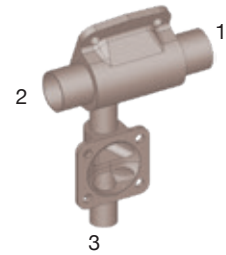

SA2.2.V

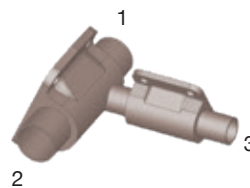

SA1.1.H

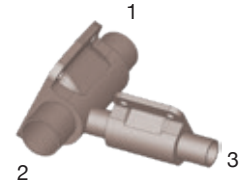

SA2.1.H

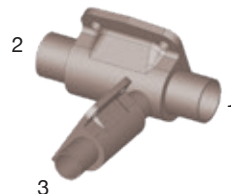

SA1.2.H

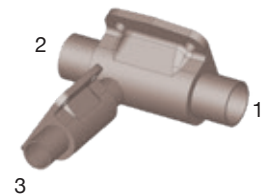

SA2.2.H

On request, all dimensional data sheets or 2D and 3D - CAD drawings are available.

All fabricated 2/2 way SA and SL orientations will have a dead leg. Manufacturing these valve orientations from a solid block body will minimize or eliminate the dead leg. See page 68 – 81.