

Pass Wall Transfer Port system

The Romynox Mousehole is a simple, though effective way to make transfer possible between two (clean) rooms. In this way you can move large volumes of liquids without the risk of bin breakage or spillage during bin transfer.

The base system consist of a stainless steel pass-through with tri-clamp connections on both sides, which can be modular extended with:

- An AdvantaPass adapter, so the system can be used with AdvantaPure assemblies. For more information, see our website.
- A Iris Valve, constructed in POM, and Iris made from white EPDM for durability and smooth actuation. This Valve is a perfect combination with the Romynox Mousehole, to provides a dust tight seal and product barrier, which prevents air flow to a minimum.

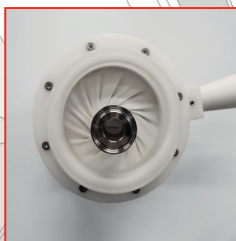

This can be done on one or both sides to give you the connections needed.

Standard sizes are 4" - 6". Other size are on request.

Standard delivered with:

- 2 x Tri-Clamps LAH
- 2 x Silicone Gaskets, Type A Flanged
- 2 x Blind End Cap
- Installation Guide

If you need other sizes or materials, please let us know.



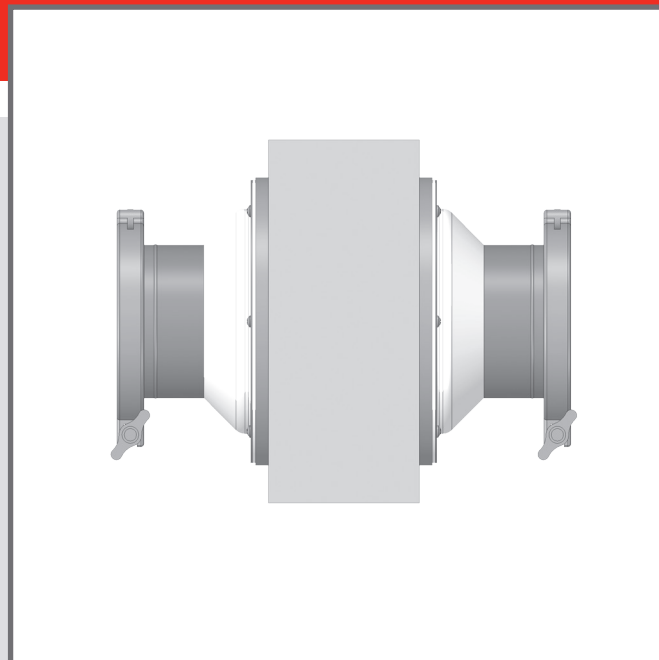

Technical information

Sizes	see table	
Connections	Tri-Clamp	
Material	Portal	Stainless Steel 316L
	End Caps	Stainless Steel 316L
	Gaskets	Platinum Cured Silicone
	Clamps	Stainless Steel 304L
	Pipettes	Silicone with Stainless Steel Ring
	Support Rings	Nylon
Finishes	SF1	
Certificates	3.1 material, FDA (on Gaskets and Pipettes), USP Class VI 121 °C, <87>, <88>, TSE/BSE	

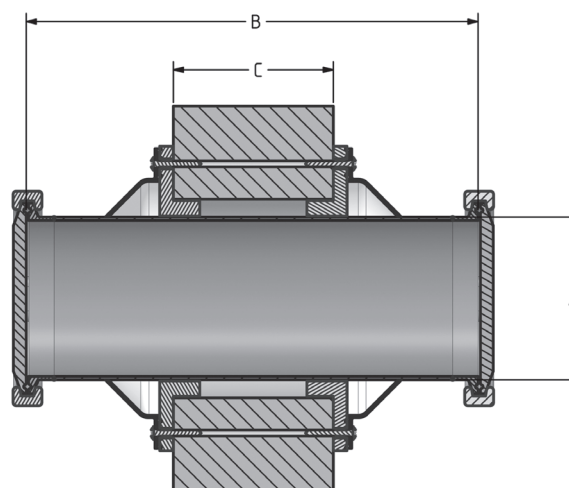

Size	ØA	B	min./max. C
4"	4" (101.6mm)	Standard 11" (280mm)	2½"/5" (63.5/127mm)
6"	6" (152.4mm)	Standard 11" (280mm)	2½"/5" (63.5/127mm)

ROMYNOX

Distributed by:

