

Kest-Lock Snap and Basic

SPECIFICATIONS

| | | |
|----------------------|---|--------------------------|
| Material Grade | EN 1.4404 | ASTM 316L or ASME 316L |
| Material requirement | EN 10 272/10028-7 | A479/A240 or SA479/SA240 |
| Documentation | Heat Certificate 3.1 acc. to EN 10 204 | |
| Surface finish | Ra ≤ [1.6 µm] [63 µin] (Snap version, outer surface polished. Basic version, outer surface grinded) | |
| Design Temperature | [-80°C to 200°C] [112°F to 392°F] | |
| Design Pressure | [-1 bar(g) to + 10 bar(g)] [-14.5 psi to 145 psi] | |
| Marking | Marked with brand, material grade, product code and heat number | |
| Packing | Sealed in vacuum plastic bag, labelled with art.number and packed in a box | |
| Gaskets | The Kest-Lock is designed for use of standard gaskets acc. to ISO 2852 type B | |
| Standard | The Kest-Lock is designed for clamp couplings acc ISO 2852, ASME BPE, DIN 32 676 | |
| Quality Assurance | Each product is controlled and tested acc. to Kest Technology quality assurance system | |

Kest-Lock Snap Ring



Kest-Lock Basic Ring

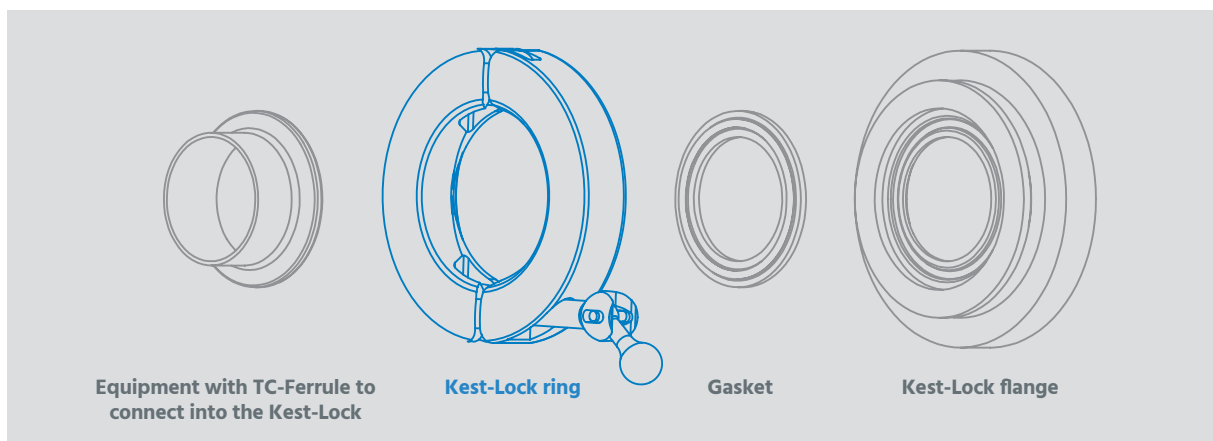

Kest-Lock Snap Ring

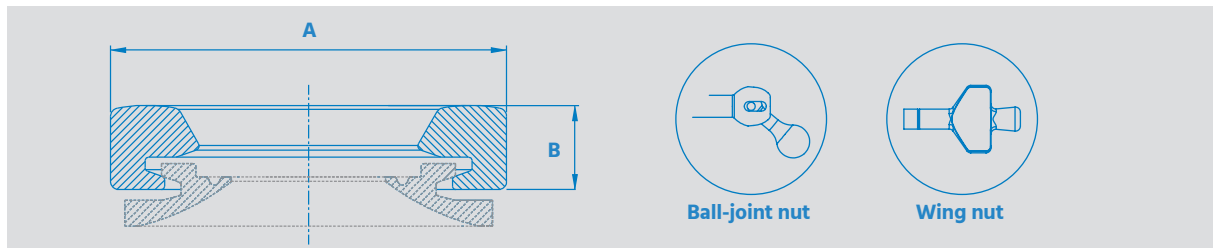

| REF. NO | SIZE TC Size [ASTM Tube size] | PRODUCT CODE | TC mm [in] | A mm [in] | B mm [in] |
|--|-------------------------------------|----------------------|------------------------|-------------------------|------------------------|
| Kest-Lock Snap ring with ball-joint nut | | | | | |
| 100012 | TC 25 [1/2" & 3/4"] | KLS-TC25-BJN | 25 [0.984] | 59 [2.323] | 20 [0.787] |
| 100013 | TC 34 [-] | KLS-TC34-BJN | 34 [1.339] | 70 [2.756] | 20 [0.787] |
| 100014 | TC 50.5 [1" & 1 1/2"] | KLS-TC50-BJN | 50.5 [1.988] | 85 [3.346] | 20 [0.787] |
| 100015 | TC 64 [2"] | KLS-TC64-BJN | 64 [2.520] | 99 [3.898] | 20 [0.787] |
| 100016 | TC 77.5 [2 1/2"] | KLS-TC77-BJN | 77.5 [3.051] | 112 [4.409] | 22 [0.866] |
| 100017 | TC 91 [3"] | KLS-TC91-BJN | 91 [3.583] | 126 [4.961] | 22 [0.866] |
| 100018 | TC 106 [-] | KLS-TC106-BJN | 106 [4.173] | 146 [5.748] | 22 [0.866] |
| 100024 | TC 119 [4"] | KLS-TC119-BJN | 119 [4.685] | 158.5 [6.240] | 24.5 [0.965] |
| Kest-Lock Snap ring with wing nut | | | | | |
| 100316 | TC 25 [1/2" & 3/4"] | KLS-TC25-WN | 25 [0.984] | 59 [2.323] | 20 [0.787] |
| 101192 | TC 34 [-] | KLS-TC34-WN | 34 [1.339] | 70 [2.756] | 20 [0.787] |
| 100297 | TC 50.5 [1" & 1 1/2"] | KLS-TC50-WN | 50.5 [1.988] | 85 [3.346] | 20 [0.787] |
| 100323 | TC 64 [2"] | KLS-TC64-WN | 64 [2.520] | 99 [3.898] | 20 [0.787] |
| 100459 | TC 77.5 [2 1/2"] | KLS-TC77-WN | 77.5 [3.051] | 112 [4.409] | 22 [0.866] |

Kest-Lock Basic Ring

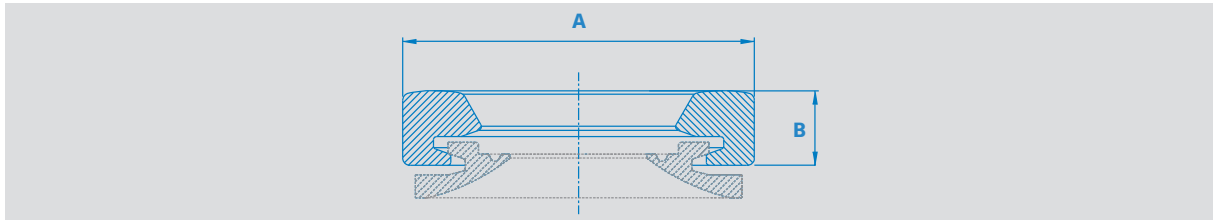

| REF. NO | SIZE TC Size [ASTM Tube size] | PRODUCT CODE | TC mm [in] | A mm [in] | B mm [in] |
|---------|-------------------------------------|----------------------|------------------------|-------------------------|------------------------|
| 100025 | TC 25 [1/2" & 3/4"] | KLB-TC25-IHS | 25 [0.984] | 59 [2.323] | 20 [0.787] |
| 100026 | TC 34 [-] | KLB-TC34-IHS | 34 [1.339] | 70 [2.756] | 20 [0.787] |
| 100027 | TC 50.5 [1" & 1 1/2"] | KLB-TC50-IHS | 50.5 [1.988] | 85 [3.346] | 20 [0.787] |
| 100028 | TC 64 [2"] | KLB-TC64-IHS | 64 [2.520] | 99 [3.898] | 20 [0.787] |
| 100029 | TC 77.5 [2 1/2"] | KLB-TC77-IHS | 77.5 [3.051] | 112 [4.409] | 22 [0.866] |
| 100030 | TC 91 [3"] | KLB-TC91-IHS | 91 [3.583] | 126 [4.961] | 22 [0.866] |
| 100031 | TC 106 [-] | KLB-TC106-IHS | 106 [4.173] | 146 [5.748] | 22 [0.866] |
| 100032 | TC 119 [4"] | KLB-TC119-IHS | 119 [4.685] | 158.5 [6.240] | 24.5 [0.965] |